

A

A

Front

210mm

HANNING by HANNSpree Quick Start Guide LCD Monitor | **HT273**

Quick setup / 快速安裝指南 / 快速安裝指南 / Schnellanleitung / Instructions rapides / Instrucciones rápidas / Istruzioni veloci / Instalação rápida / Snelle installatie / Выстрая настройка

PL050 600 273HSR # HT273_Q_EUR_V01

Contents of the Package
LCD Monitor (Reference only, the real figure is depended on selected model)
Screen
Accessory: Audio Cable (optional), VGA Cable, Quick Start Guide, Warranty Card (optional), Power Adaptor, Power Cord, USB Cable

Making Connections
[Optional, depend on selected model]

Control Buttons
MENU: Menu / Return
Volume adjustment button
Brightness adjustment button
Auto adjustment Enter (Analog Input Models)
Input source change Enter (Digital Input Models)
Power Button

Recycling Information
We at HANNSpree, care very much about our environment protection strategy and firmly believe that it helps us have healthier earth with appropriate treatment and recycling of industrial technology devices at the end-of-life. These devices contain recyclable materials, which can be re-decomposed and re-integrated into brand-new materials. On the contrary, other material can be classified as hazardous and poisonous substances. We strongly encourage you to contact the provided information to recycle this product.

FCC Class B Radio Frequency Interference Statement
This Class B digital apparatus meets all requirements of the Canadian Interference-Causing Equipment Regulation. [Optional, depend on selected model]

CE
This device complies with requirement of EMC directive 2004/108/EC with regard to Electromagnetic Compatibility, and 2006/95/EC and PSM/REK with regard to Low Voltage directive. [Optional, depend on selected model]

Warranty, Service and Support
Need help? Contact us, details at <http://hannspree.eu/en/support>

Trademark Notice
HDMI HANNS.G products incorporate High-Definition Multimedia Interface (HDMI™) technology. The terms HDMI and HDMI High-Definition Multimedia Interface, and the HDMI Logo are trademarks or registered trademarks of HDMI Licensing LLC in the United States and other countries.

Thank you for purchasing this HANNSpree product. To download the user's manual or driver, please visit the following website: <http://www.hannspree.eu/en/monitors>

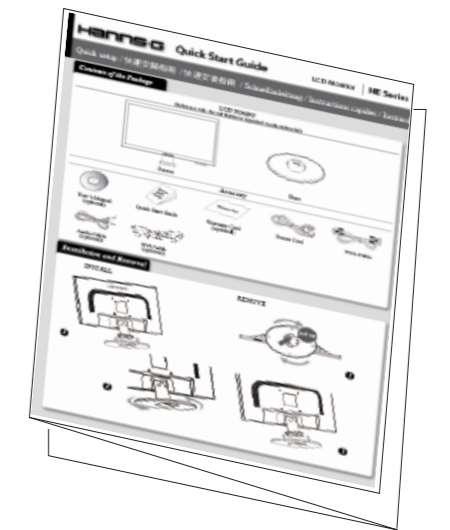

(此面朝上)
上圖僅作折疊方式參考

- 加工方式:
1. 模造紙80P
 2. 單色印刷
 3. 折合方式:彈簧三折(成品尺寸148 x 210mm)

注意: 左邊內容中紅色線框標識的地方要依據不同Brand來進行更新 (EX: HANNS.G / HANNSPREE)

Brand name by model:

HANNSpree (For WW)

HANNS.G (Only For EUR)

HANNS.G by HANNSpree

- NOTES:
- Revise Items:
1. Sales name (5 code)(Arial Black,Italic,14pt)
 2. P/N (Arial,Regular,7pt)
 3. Version name: follow AW name rule (Arial,Regular,7pt)
 4. QGS template version (Arial ,Regular,7pt)
 5. Adaptor Source (供應商Adaptor型號)
 6. 內容依據機種實際規格修改

- Follow Rules:
1. Contents of the Package: (機台圖面必須與實際機台相符, Accessory 必須與Accessory spec 相符) <PM,PJM,ME,Artwork>
 2. Installation and Removal 圖示及描述必須與實際機台相符) <PM,PJM,ME,Artwork>
 3. I/O Ports Connection圖示及描述必須與實際機台& Product spec 相符 <PM,PJM,ME,Artwork>
 4. Control Buttons 圖示及描述必須與實際機台& Product spec相符 <PM,PJM,ME,Artwork>
 5. 內文整體編排 (含字型) <Artwork>
 6. 內容字型: 簡中及繁中: 新細明體/其它語言: Times New Roman

* 依據機種實際規格使用,放入Safety內容區域,適當排版。

Trademark Notice
HDMI HANNS.G products incorporate High-Definition Multimedia Interface (HDMI™) technology. The terms HDMI and HDMI High-Definition Multimedia Interface, and the HDMI Logo are trademarks or registered trademarks of HDMI Licensing LLC in the United States and other countries. (請依照機種實際規格使用,請參照Product spec)

Lamp Disposal
LAMP(S) INSIDE THIS PRODUCT CONTAIN MERCURY AND MUST BE RECYCLED OR DISPOSED OF ACCORDING TO LOCAL, STATE OR FEDERAL LAWS. FOR MORE INFORMATION, CONTACT THE ELECTRONIC INDUSTRIES ALLIANCE AT WWW.EIAE.ORG. FOR LAMP SPECIFIC DISPOSAL INFORMATION CHECK WWW.LAMPRECYCLE.ORG

(Hq警語僅適用CCFL 機種, LED backlight需刪除此段)

D

Back

Quick setup / **Adaptor Source** P/N:48-48A / **Stručni priručnik** / **Adaptivný zdroj** P/N:48-48A / **Справка установки** / **Zařízení z rozličeza** P/N:48-48A / **Schnellanleitung** / **Netzteilsquelle** P/N:48-48A / **Instructions rapides** / **Source de l'alimentation** P/N:48-48A

1. Power on the computer and monitor.
2. Start the operating system.
3. From the Main Menu, click on the options you would like to perform and follow the directions on the screen.

Troubleshooting

Problems	Check items
No display	Check whether the power of screen is on or not.
The power LED is off	Ensure the power cord is connected to power properly.
No display	Ensure the power supply is normally in the outlet by using.
The power LED is in the color of orange	Ensure the computer is not in the power save mode. Minus mouse or hit any key to wake up the computer.
The power LED is in the color of yellow	Ensure the computer or the equipment of video source is in a normal mode.
The power LED keeps flashing	Ensure the video signal cable is connected properly. (The availability of the function depends upon the selected model)

Warning: To reduce the risk of electric shock or damage to your equipment, do not disable the power cord grounding plug. The grounding plug is an important safety feature.
1. Plug the power cord into a grounded (earthed) electrical outlet that is easily accessible at all times.
2. Disconnect power from the monitor by unplugging the power cord from the electrical outlet.

Instalaciones rápidas
1. Active el ordenador y el monitor.
2. Partiendo desde el menú principal, haga clic en las funciones deseadas y siga las instrucciones que aparecen en la pantalla.

Schůlna de problemas

Problemas	Causas que comprobar
No hay señal de imagen	Compruebe si la alimentación de la pantalla está activada o desactivada.
No se enciende la lámpara en amarillo	Compruebe si el cable de alimentación está correctamente conectado a la pantalla.
No hay señal de imagen	Compruebe si la fuente de alimentación está conectada a la toma de corriente por un conector de tierra.
No enciende el color naranja	Compruebe si el ordenador no está en modo de ahorro de energía.
La lámpara de la disponibilidad de esta función depende del modelo seleccionado	Compruebe si está activado el módulo de vídeo.
El LED se enciende y parpadea	Compruebe si el cable de vídeo está conectado correctamente.

Advertencia: Para evitar descargas de corriente eléctrica o daños a su equipo, no desactive el enchufe de tierra de la toma de tierra. La toma de tierra representa una característica importante de seguridad.
1. Conecte la toma del cable de tierra con una toma de enchufe prevista de tierra y a la que se acceda fácilmente en todo momento.
2. Extraiga el enchufe de la red cuando quiera separar el monitor del ordenador.

Instalation rapide
1. Activez le moniteur et le ordinateur.
2. Partant du menu principal, cliquez sur les options que vous souhaitez effectuer et suivez les instructions qui se trouvent à l'écran.

Eliminazione dei problemi

Problemi	Soluzioni
Nessun segnale video	Verificare se il monitor è collegato.
La lampada non si accende in giallo	Verificare se il cavo di alimentazione è collegato correttamente alla schermata.
Nessun segnale video	Verificare se il cavo di alimentazione è correttamente collegato alla presa di corrente a terra.
Nessun segnale video	Assicurarsi che il computer non è in uno stato di risparmio di energia.
La lampada di disponibilità di questa funzione dipende dal modello selezionato	Verificare se il computer è acceso.
	Verificare se il cavo VGA è collegato correttamente.

Avvertenza: Per evitare scosse elettriche o danni al proprio equipaggiamento, non disattivare il collegamento a terra. Il collegamento a terra costituisce un importante requisito di sicurezza. A ficha con ligação à terra constitui uma importante medida de segurança.
1. Não desative a ficha com ligação à terra do cabo de alimentação. A ficha com ligação à terra constitui uma importante medida de segurança.
2. Ligue a ficha a uma tomada elétrica com ligação à terra e de fácil acesso.
3. Desligue a alimentação do monitor retirando o cabo de alimentação da tomada elétrica.

Instalation rapida
1. Lige o computerul și monitorul.
2. Faceți o opțiune operativă.
3. Nu apăsați pe opțiuni pe care doriți să le realizați decât după ce ați citit instrucțiunile de pe ecran.

Resolucão de problemas

Problema	Verifique se seguiu estes passos
Sem sinal de vídeo	Verifique se a alimentação do monitor está ou não ligada.
O LED de disponibilidade desta função depende do modelo selecionado	Verifique se o computador está ligado.
Sem sinal de vídeo	Verifique se o cabo de alimentação está devidamente ligado à tomada elétrica.
O LED de disponibilidade desta função depende do modelo selecionado	Verifique se o computador não está em modo de economia de energia.
O LED de disponibilidade desta função depende do modelo selecionado	Verifique se o computador está ligado.
O LED de disponibilidade desta função depende do modelo selecionado	Verifique se o cabo VGA está devidamente ligado.

Atenção: Para reduzir o risco de choque elétrico ou o risco de danos ao nível do equipamento.
1. Não desative a ficha com ligação à terra do cabo de alimentação. A ficha com ligação à terra constitui uma importante medida de segurança.
2. Ligue a ficha a uma tomada elétrica com ligação à terra e de fácil acesso.
3. Desligue a alimentação do monitor retirando o cabo de alimentação da tomada elétrica.

Schnellführung
1. Schalten Sie den Computer und den Monitor ein.
2. Wählen Sie im Menüprinzip, klicken Sie auf die gewünschten Funktionen und folgen Sie den Anweisungen am Bildschirm.

Problemlösung

Probleme	Lösung
Kein Bildsignal	Prüfen Sie, ob das Monitor angeschaltet ist.
Die Betriebslampe leuchtet nicht	Prüfen Sie, ob das Netzkabel korrekt angeschlossen ist.
Kein Bildsignal	Prüfen Sie, ob das Netzkabel in der Steckdose steckt.
Die Betriebslampe leuchtet orange (Die diese Funktion vorhanden ist, hängt von dem ausgewählten Modell ab)	Prüfen Sie, ob der Computer eingeschaltet ist.
Die Betriebslampe leuchtet gelb	Prüfen Sie, ob das VGA-Kabel korrekt angeschlossen ist.

Warnung: zur Vermeidung elektrischer Stromschläge. Das Erdungskabel ist ein wichtiges Sicherheitsmerkmal der. Verbinden Sie das Netzkabel mit einer geerdeten Steckdose, die jederzeit gut erreichbar ist.
1. Ziehen Sie den Netzstecker, wenn Sie den Monitor vom Computer trennen wollen.

Schnell installatie
1. Zet de computer en de monitor aan.
2. Kies het bevoegdmenu.
3. Klik in het hoofdmenu op de opties die u wilt uitvoeren en volg de instructies op het scherm.

Probleemoplossing

Probleem	Controleer de onderdelen
Geen video	Controleer de stroom van het scherm aan of uit.
De stroom LED gaat niet branden	Controleer de aarding van het scherm.
Geen video	Controleer de stroom in het stopcontact met een stopcontact.
De stroom LED brandt in de kleur oranje (De beschikbare functie is afhankelijk van het geselecteerde model)	Controleer of de computer is ingeschakeld.
De stroom LED brandt in de kleur geel	Controleer of de video kabel correct is aangesloten.
De stroom LED brandt in de kleur geel	Controleer of de videoaansluiting goed is aangesloten.

Waarschuwing: Om het risico van elektrische schokken of schade aan uw materiaal te beperken.
1. Het aardingstekker van de monitor moet verbonden maken. De aarding is een belangrijk veiligheidsmerk.
2. Steek de stroomkabel in een geaard elektrisch stopcontact dat altijd makkelijk te bereiken is.
3. Schakel de stroom van de monitor uit door de stroomkabel uit het elektrische stopcontact te halen.

F

F

V01	DESCRIPTION								
VERSION									

SCALE	DRAWN BY	DATE	DRAWING NAME
1:1		2014/07/17	
UNIT	CHECKED BY	DATE	H_HT273_Q_EUR_V01
mm			
SHEET	APPROVED BY	DATE	PART NAME
1/1			
HannStar Display Corp.			PART. NO.
			REV. V01