

A

A

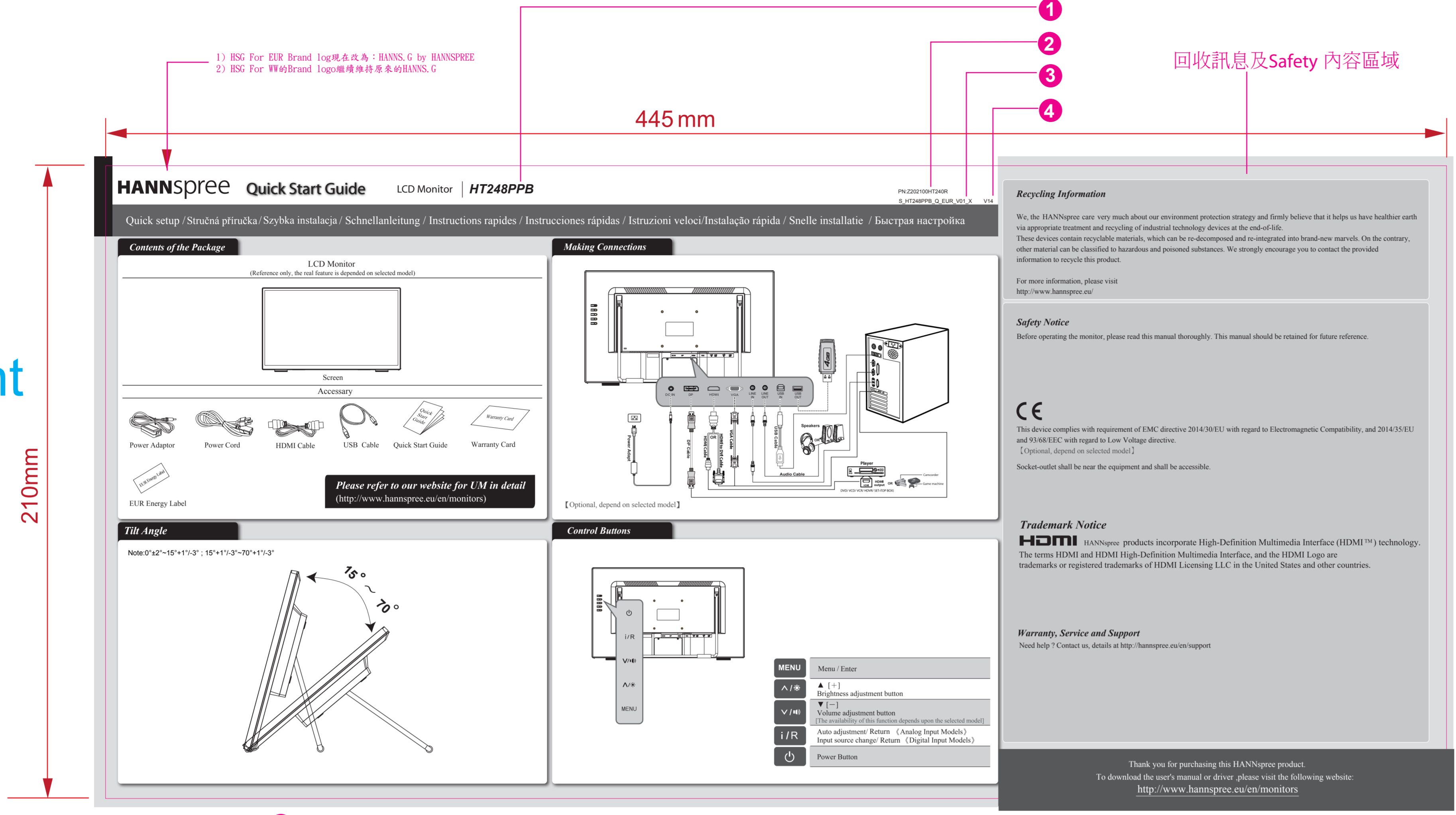

Front

210mm

回收訊息及Safety 內容區域

加工方式:

- 1. 模造紙80P
- 2. 單色印刷
- 3. 折合方式:彈簧三折(成品尺寸148 x 210mm)

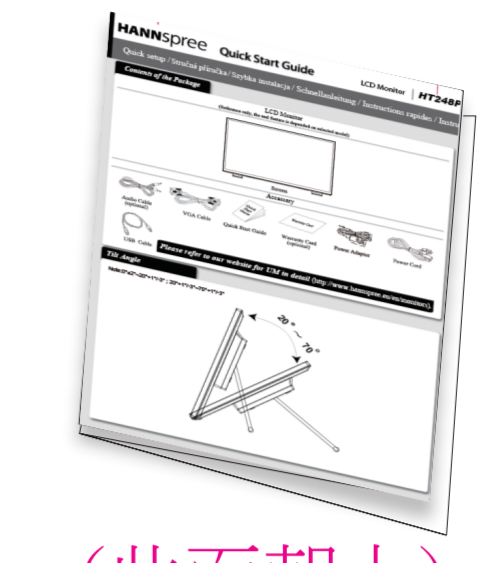

(此面朝上)

注意: 左邊內容中紅色線框標識的地方要依據不同Brand來進行更新  
(EX: HANNS.G by HANNSpree / HANNSPREE)

B

B

C

C

NOTES

Revise Items:

- 1. Sales name (8 code)(Arial Black,Italic,14pt)
- 2. P/N (Arial,Regular,7pt)
- 3. Version name: follow AW name rule (Arial,Regular,7pt)
- 4. QGS template version (Arial ,Regular,7pt)
- 5. Adaptor Source (供應商Adaptor型號)
- 6. 內容依據機種實際規格修改

Follow Rules:

- 1. Contents of the Package: (機台圖面必須與實際機台相符, Accessory 必須與Accessory spec 相符) <PM,PJM,ME,Artwork>
- 2. Installation and Removal 圖示及描述必須與實際機台相符) <PM,PJM,ME,Artwork>
- 3. I/O Ports Connection圖示及描述必須與實際機台& Product spec 相符 <PM,PJM,ME,Artwork>
- 4. Control Buttons 圖示及描述必須與實際機台& Product spec相符 <PM,PJM,ME,Artwork>
- 5. 內文整體編排 (含字型) <Artwork>
- 6. 內容字型: 簡中及繁中:新細明體/其它語言: Times New Roman

\* 依據機種實際規格使用,放入Safety內容區域,適當排版。

Back

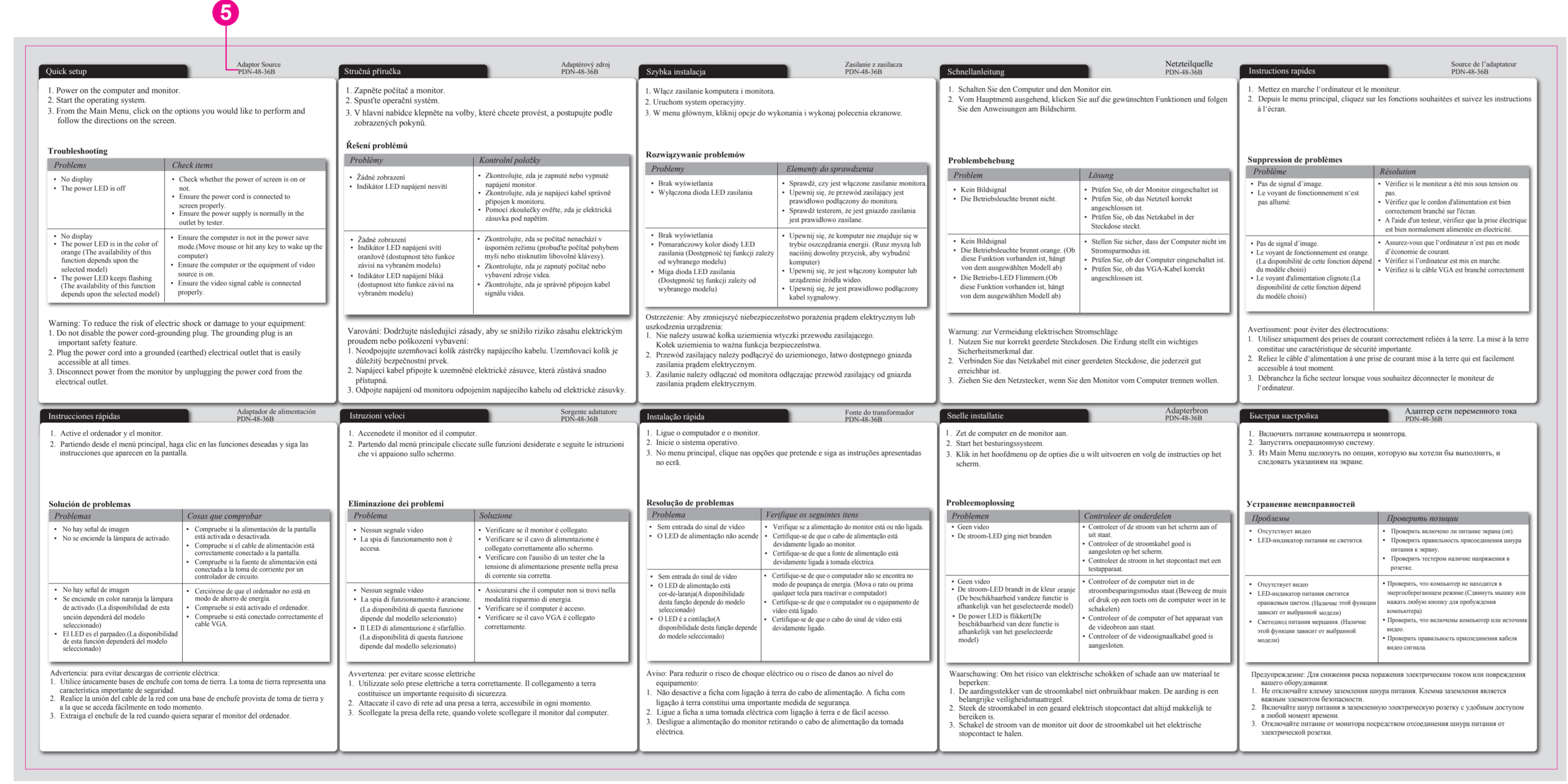

**Trademark Notice**  
HannStar G products incorporate High-Definition Multimedia Interface (HDMI™) technology. The terms HDMI and HDMI High-Definition Multimedia Interface, and the HDMI Logo are trademarks or registered trademarks of HDMI Licensing LLC in the United States and other countries.  
(請依照機種、品牌、實際規格使用,請參照Product spec)

**Lamp Disposal**  
LAMP(S) INSIDE THIS PRODUCT CONTAIN MERCURY AND MUST BE RECYCLED OR DISPOSED OF ACCORDING TO LOCAL, STATE OR FEDERAL LAWS. FOR MORE INFORMATION, CONTACT THE ELECTRONIC INDUSTRIES ALLIANCE AT WWW.EIAE.ORG. FOR LAMP SPECIFIC DISPOSAL INFORMATION CHECK WWW.LAMPRECYCLE.ORG.  
(Hg警語僅適用CCFL 機種, LED backlight需刪除此段)

D

D

E

E

Quick setup\_10 國語言順序

- EN (英文)
- CZ (Czech 捷克文)
- PL (Polish 波蘭文)
- DE (German 德文)
- FR (French 法文)
- ES (Spanish 西班牙文)
- IT (Italy 義大利文)
- PT (Portuguese 葡萄牙文)
- NL (Dutch 荷蘭文)
- RU (Russian 俄羅斯文)

F

F

V01	
VERSION	DESCRIPTION

SCALE	DRAWN BY	DATE	DRAWING NAME
1:1	Damon	2018/06/21	S_HT248PPB_Q_EUR_V01_X
UNIT	CHECKED BY	DATE	PART NAME
mm			HP248PPB
SHEET	APPROVED BY	DATE	
1/1			
HannStar Display Corp.			PART.NO. Z202100HT240R
			REV. 15