

Biformat Tensio is a screen designed to meet even the highest expectations in the home cinema market. This is achieved thanks to a technical profile and a unique tensioning system. Inside the same case are two distinct projection surfaces of different formats, bordered with special non-varnished anti-reflective black edges. These enable to enhance the contrast of the projected image much more effectively than traditional 3 cm edges.

In addition to being positioned in direct contact with each other, to avoid focus loss, the projection surfaces are fixed to the roller, in such a way as to eliminate all risks of annoying horizontal crease marks. Furthermore, the front drop of the surface and the vertical alignment of the rollers ensure planarity. The motorized rolling is controlled through a wall-mounted remote control or an integrated radio receiver.

The case is white (RAL 9016), with brushed aluminium lateral ends, which completely mask the screws. Owing to the practical anchoring system, use is immediately possible.



Tensioned Screens

Create your own screen with the PSS:

- > **personalized dimensions:** width
- > **roller type:** standard motorized or radio integrated
- > **case:** available only with case
- > **case color:** available only in white with brushed aluminium lateral ends
- > **projection surfaces:** ReferenceWhite, ReferenceGrey, VisionWhite, VisionWhitePro, VisionAcoustik, available only with black borders
- > **special option:** Deco Print
- > **height of top:** from 10 to 40 cm
- > **projection surface drop:** front only
- > **side of command/motor:** right only

Standard accessories:

- > kit with wall -or ceiling- quick mount brackets
- > 2 unipolar selector switches
- > Remote control for radio integrated screens

Optional accessories:

- > receiver and RF remote control for motorized screen (3 modalities: basic, automatic and compatible with domotic systems)
- > receiver and infrared remote control
- > bracket extensions for screens up to 60 cm

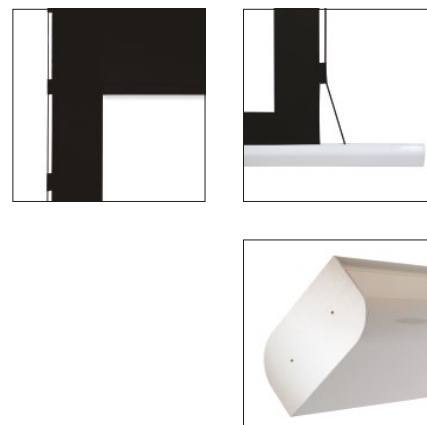

All you need to do is choose among the numerous formats available:

- > 1.33 NTSC PAL 4:3
- > 1.66 Wide European
- > 1.78 HDTV 16:9
- > 1.85 Wide
- > 2.35 Cinemascope 21:9
- > 2.40 Panavision

All of them boast perfect tensioning, thanks to the classic tensioning system. Two elastic cables depart from the base and are threaded through dedicated same-size eyelets, placed along the sides of the screen: the arch that forms laterally ensures a harmonious aesthetic impact and a crease-free rolling, despite the presence of the eyelets.

Format	Overall Width	Overall Height	Surface Width	Surface Height	Net Surface Width	Net Surface Height	Standard Top	Maximum Total Top	Shipment Sizes	Net Weight	Gross Weight
	A	E	F	G	H	I	P	cm	cm	Kg	Kg
Biformat	225	223	193	198	183	183	10	40	233x30x33	34	39
	250	248	218	223	208	208	10	40	258x30x33	40	45
	275	273	243	248	233	233	10	40	283x30x33	47	52
	300	298	268	273	258	258	10	40	308x30x33	55	60
	325	323	293	298	283	283	10	40	333x30x33	58	63
	350	348	318	323	308	308	10	40	358x30x33	60	65

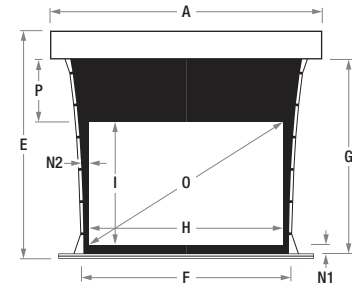

Configuration Examples	Native Format	Ratio	Net Surface Width		Diagonal Inches	Standard Top	Bottom Border	Lateral Border
			H	I				
225	4:3	1.33	183	137	90	10	5	5
	4:3	1.33	183	137	90	10	5	5
	16:9	1.78	183	103	83	10	5	5
	16:9	1.78	183	103	83	10	5	5
	21:9	2.35	183	78	78	10	5	5
	21:9	2.35	183	78	78	10	5	5
250	4:3	1.33	208	156	102	10	5	5
	4:3	1.33	208	156	102	10	5	5
	16:9	1.78	208	117	94	10	5	5
	16:9	1.78	208	117	94	10	5	5
	21:9	2.35	208	89	89	10	5	5
	21:9	2.35	208	89	89	10	5	5
275	4:3	1.33	233	175	115	10	5	5
	4:3	1.33	233	175	115	10	5	5
	16:9	1.78	233	131	105	10	5	5
	16:9	1.78	233	131	105	10	5	5
	21:9	2.35	233	99	100	10	5	5
	21:9	2.35	233	99	100	10	5	5
300	4:3	1.33	258	194	127	10	5	5
	4:3	1.33	258	194	127	10	5	5
	16:9	1.78	258	145	117	10	5	5
	16:9	1.78	258	145	117	10	5	5
	21:9	2.35	258	110	110	10	5	5
	21:9	2.35	258	110	110	10	5	5
325	4:3	1.33	283	212	139	10	5	5
	4:3	1.33	283	212	139	10	5	5
	16:9	1.78	283	159	128	10	5	5
	16:9	1.78	283	159	128	10	5	5
	21:9	2.35	283	120	121	10	5	5
	21:9	2.35	283	120	121	10	5	5
350	4:3	1.33	308	231	152	10	5	5
	4:3	1.33	308	231	152	10	5	5
	16:9	1.78	308	173	139	10	5	5
	16:9	1.78	308	173	139	10	5	5
	21:9	2.35	308	131	132	10	5	5
	21:9	2.35	308	131	132	10	5	5

2 nd Format	Ratio	Net Surface Width		Diagonal Inches	Standard Top	Bottom Border	Lateral Border
		H	I				
16:9	1.78	183	103	83	27	5	5
	2.35	183	78	78	40	5	5
21:9	2.35	183	78	78	22	5	5
	4:3	1.33	137	103	67	10	28
16:9	1.78	139	78	63	10	5	27
	4:3	1.33	104	78	51	10	45
16:9	1.78	208	117	94	30	5	5
	2.35	208	89	89	44	5	5
21:9	2.35	208	89	89	24	5	5
	4:3	1.33	156	117	77	10	31
16:9	1.78	158	89	71	10	5	30
	4:3	1.33	118	89	58	10	50
16:9	1.78	233	131	105	32	5	5
	2.35	233	99	100	48	5	5
21:9	2.35	233	99	100	26	5	5
	4:3	1.33	174	131	86	10	34
16:9	1.78	176	99	80	10	5	33
	4:3	1.33	132	99	65	10	55
16:9	1.78	258	145	117	34	5	5
	2.35	258	110	110	52	5	5
21:9	2.35	258	110	110	28	5	5
	4:3	1.33	193	145	95	10	37
16:9	1.78	195	110	88	10	5	36
	4:3	1.33	146	110	72	10	61
16:9	1.78	283	159	128	37	5	5
	2.35	283	120	121	56	5	5
21:9	2.35	283	120	121	29	5	5
	4:3	1.33	212	159	104	10	41
16:9	1.78	214	120	97	10	5	39
	4:3	1.33	161	120	79	10	66
16:9	1.78	308	173	139	39	5	5
	2.35	308	131	132	60	5	5
21:9	2.35	308	131	132	31	5	5
	4:3	1.33	231	173	114	10	44
16:9	1.78	233	131	105	10	5	42
	4:3	1.33	175	131	86	10	72

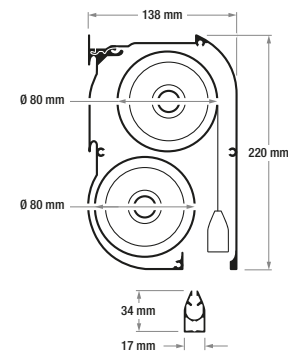

PSS formats



Surfaces Fireproof Certification

