



The **OPEN ROLL** model has been studied to be installed in pretty large rooms like concert halls, cinemas, auditoriums and conference rooms. Open Roll assures great success in projections thanks to its high quality standard. This screen has the particular feature to be without housing.

Available in 4:3, 16:9 and 16:10 ratios or bespoke sizes.

**MOUNTING BRACKET:
SHAFT SIDE**

**MOUNTING BRACKET:
MOTOR SIDE**

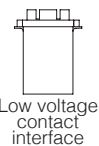
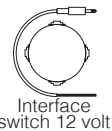
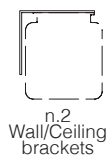
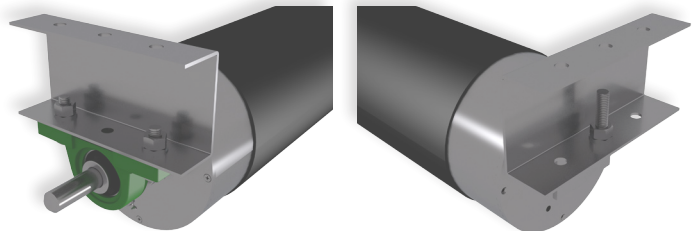

INCLUDED

OPTIONAL pag 62-63



**MOUNTING BRACKET:
SHAFT SIDE (LEFT)**

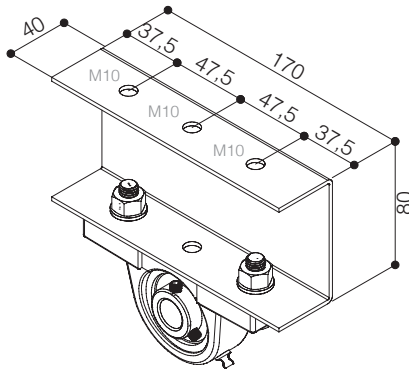

**MOUNTING BRACKET:
MOTOR SIDE (RIGHT)**

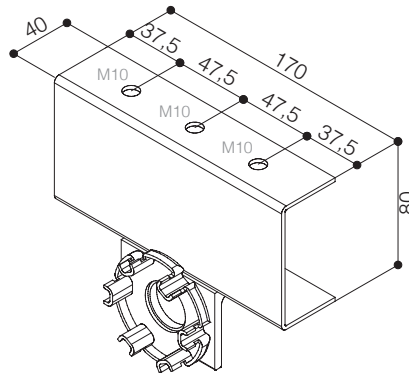

WALL MOUNTING

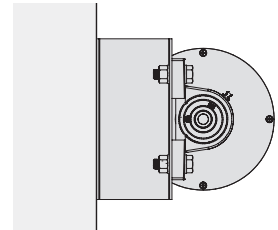

CEILING MOUNTING

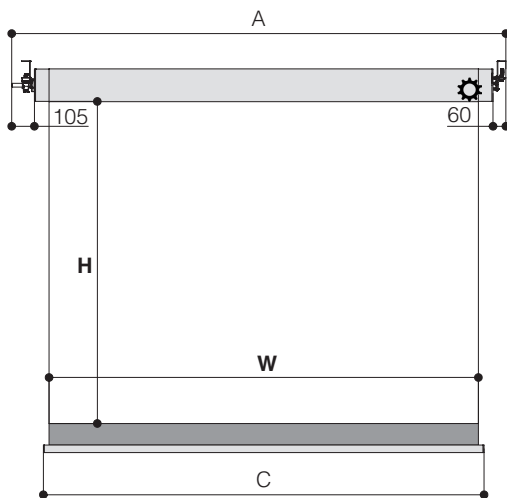
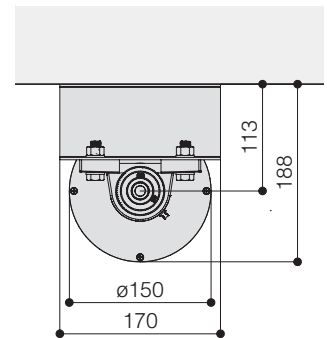

TECHNICAL SPECIFICATIONS

- Silent motor system provides a smooth and quiet operation

- Power: **40 Nm**
- Speed: **17 rpm**
- Power supply: **230V / 50 Hz**
- Consumption: **322 W**
- Certification: **IMQ**

AVERAGE TIME OF ROLLING UP/DOWN	
H (cm)	Sec.
375	30
450	36
525	42

- Strong steel and aluminium construction
- Black dowel bar: height 35 mm. - depth 20 mm.
- Standard black bottom border of 10 cm.
- Two mounting brackets for ceiling or for wall
- On/Off switcher included
- Power cable located at **right** side of the screen, seen from the front
- Flame retardant projection surfaces - classification M1, M2 and B1
- Side black borders of 5 cm. (*optional*)

The measures in the drawings are expressed in millimetres.

DIMENSIONS measures in cm

4:3 Ratio Viewing area (WxH)	16:9 Ratio Viewing area (WxH)	16:10 Ratio Viewing area (WxH)	Overall dimensions A - C	Approx. net weight (Kg)
500 x 375	500 x 313	500 x 281	530 - 505	52
600 x 450	600 x 375	600 x 337	630 - 605	63
700 x 525	700 x 437	700 x 394	730 - 705	73

PROJECTION CLOTHS

Front projection surfaces	Gain	Rear projection surfaces <i>**no black borders**</i>	Gain
White	1.2	Rear Plus	1.1
Matte White	1.2	Front Rear	0.9
Microholes	1.0		

Warranty: 5 years on the motor - 24 months on the other components

