

A wide choice of formats, also in the tensioned version, with the Multiformat screen: surpassing the highest expectations of home cinema lovers.

Starting from two independent projection surfaces (a top masking surface and a rear projection surface), attached to two rollers: by synchronising these you can vary the format of the projection area, and obtain an image which is always edged in black, enhancing contrast. These are special, non-varnished anti-reflective black edges, with a width of 7 cm (while traditional edges are 3 or 5 cm wide).

The top surface is directly in contact with the rear surface, thanks to the vertical alignment of the rollers: this avoids the formation of shadows during projection. Planarity is ensured by the front drop of the surface, while the special anchoring to the roller eliminates any risks of horizontal crease marks. A perfect surface is possible at all times, thanks to a dedicated command that unrolls the surface completely, to facilitate cleaning operations. The winding is through ILT2 Somfy motors with electronic limit switches to control encoders, synchronization and storage are managed by the control unit ILT4 (RS232/485) and infrared remote control. The case is white (RAL 9016), with brushed aluminium lateral ends, which completely mask the screws. The anchoring system is simple and super-quick, for easy installation procedures.



Create your own screen with the PSS:

- > **personalized dimensions:** width
- > **formats:** 8 different configurations
- > **roller type:** only radio integrated
- > **case:** available only with case
- > **case color:** available only in white with brushed aluminium lateral ends
- > **projection surfaces:** ReferenceWhite, ReferenceGrey, VisionWhite, VisionWhitePro, VisionAcoustik, only with black borders
- > **height of top:** from 10 to 40 cm
- > **projection surface drop:** front only
- > **side of command/motor:** right only

Standard accessories:

- > kit with wall -or ceiling- quick mount brackets
- > control unit ILT4 Somfy
- > infrared receiver
- > 8 channel infrared transmitter

Optional accessories:

- > bracket extensions for screens up to 60 cm

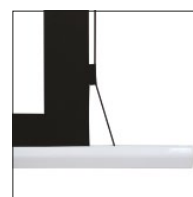

Tensioned Screens

There is a very ample variety of formats to choose from

For projectors with a 4:3 aspect ratio the following formats are available:

- > 1.33 NTSC PAL 4:3
- > 1.66 Wide European
- > 1.78 HDTV 16:9
- > 1.85 Wide
- > 2.35 Cinemascope 21:9
- > 2.40 Panavision

For projectors with a 16:9 aspect ratio the following formats are available:

- > 1.78 HDTV 16:9
- > 1.85 Wide
- > 2.35 Cinemascope 21:9
- > 2.40 Panavision

Two more formats, with height lower than that of the starting format, can be added according to choice.

Numerous solutions, but only one tensioning system: a classic. Two elastic cables depart from the base and are threaded through dedicated same-size eyelets, placed along the sides of the screen: the arch that forms laterally ensures a harmonious aesthetic impact and a crease-free rolling, despite the presence of the eyelets.

Format	Overall Width	Overall Height	Surface Width	Surface Height	Net Surface Width	Net Surface Height	Standard Top	Maximum Total Top	Diagonal Inches	Shipment Sizes	Net Weight	Gross Weight
	A	E	F	G	H	I	P	cm	O	cm	kg	kg
4:3	225	177	193	151	179	134	10	40	88	233x30x33	34	39
	250	195	218	170	204	153	10	40	100	258x30x33	40	45
	275	214	243	189	229	172	10	40	113	283x30x33	47	52
	300	233	268	208	254	191	10	40	125	308x30x33	55	60
	325	252	293	226	279	209	10	40	137	333x30x33	58	63
1.66 Wide European	225	150	193	125	179	108	10	40	82	233x30x33	34	39
	250	165	218	140	204	123	10	40	94	258x30x33	40	45
	275	180	243	155	229	138	10	40	105	283x30x33	47	52
	300	195	268	170	254	153	10	40	117	308x30x33	55	60
16:9	225	143	193	118	179	101	10	40	81	233x30x33	34	39
	250	157	218	132	204	115	10	40	92	258x30x33	40	45
	275	171	243	146	229	129	10	40	103	283x30x33	47	52
	300	185	268	160	254	143	10	40	115	308x30x33	55	60
1.85 Widescreen	225	139	193	114	179	97	10	40	80	233x30x33	34	39
	250	153	218	127	204	110	10	40	91	258x30x33	40	45
	275	166	243	141	229	124	10	40	102	283x30x33	47	52
	300	180	268	154	254	137	10	40	114	308x30x33	55	60
21:9	225	119	193	93	179	76	10	40	77	233x30x33	34	39
	250	129	218	104	204	87	10	40	87	258x30x33	40	45
	275	140	243	114	229	97	10	40	98	283x30x33	47	52
	300	150	268	125	254	108	10	40	109	308x30x33	55	60
	325	161	293	136	279	119	10	40	119	333x30x33	58	63

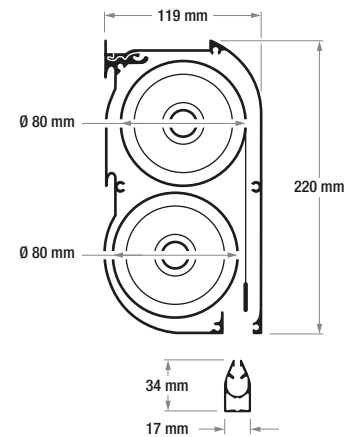
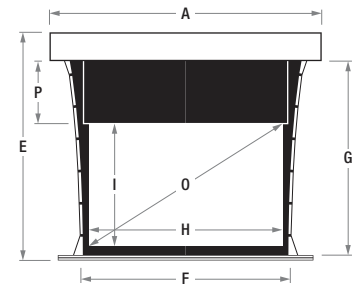

Surfaces Fireproof Certification

B1 M1

PSS formats

